

4

3

2

1

D

D

C

C

B

B

A

A

CHARGING HANDLE

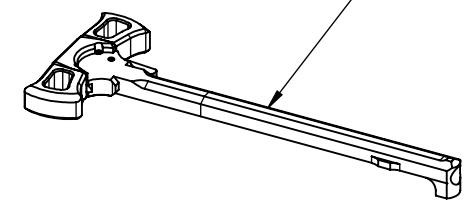

QD LOCKING LUG SCREW

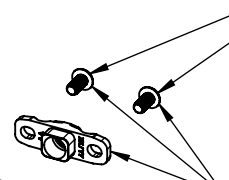

QD LOCKING LUG KIT

RENEGADE HANDGUARD  
14.5" NON WINDOW

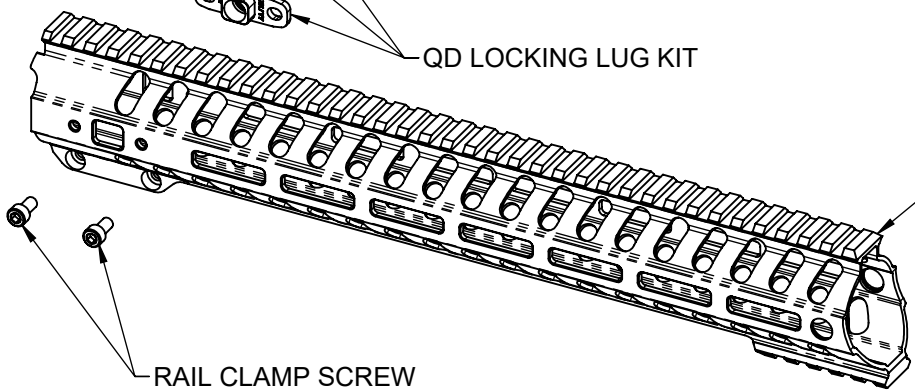

FIRING PIN  
RETAINING PIN

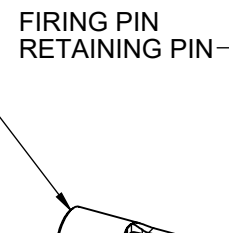

ROLLER CAM PIN



RAIL CLAMP SCREW

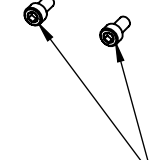

BOLT CARRIER

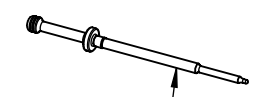

FORWARD ASSIST  
SPRING



FORWARD ASSIST  
RETAINING PIN



FIRING PIN

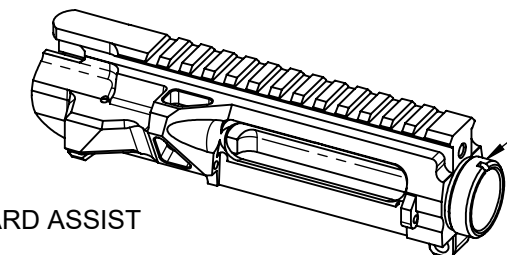

UPPER RECEIVER

EJECTOR ROLL PIN



FORWARD ASSIST



BOLT

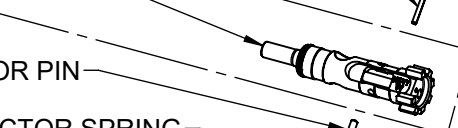

EJECTOR

EXTRACTOR PIN

EXTRACTOR SPRING

EXTRACTOR

EJECTOR SPRING

EXTRACTOR KIT

EJECTION PORT  
COVER SPRING

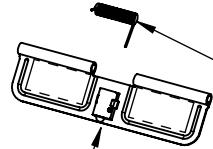

EJECTION PORT COVER ROD

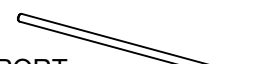

EJECTION PORT C CLIP



EJECTION PORT  
COVER ASSY

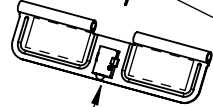

RIFLE LENGTH  
DICTATOR GAS BLOCK KIT

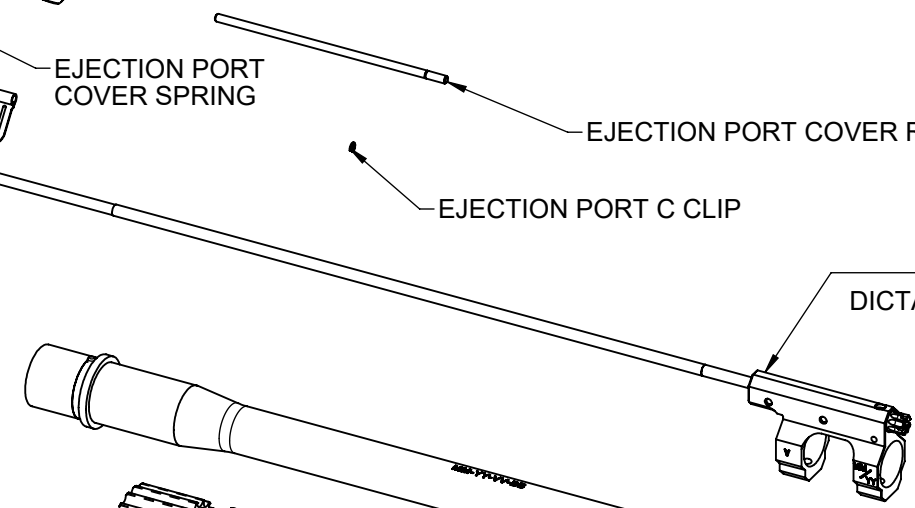

HEAT SINK  
BARREL NUT

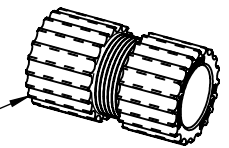

LOCK NUT



GAS BLOCK SET SCREWS



MUZZLE BRAKE

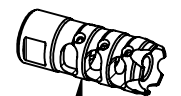

**POF-USA CMR DI UPPER RECEIVER COMPONENTS BY PART DESCRIPTION**

**REV DATE: 10/16/2020**

4

3

2

1

4

3

2

1

D

D

C

C

B

B

A

A

COMPLETE ASSY  
 00849 (TOMAHAWK) SHOWN  
 00782 (RATTLER)  
 00813 (ARCHANGEL)  
 01542 (STRIKE EAGLE)

01011

01010 KIT

01034

00954

00307

01632

00940

01492

00886

00930

00952

01493

00929

01410  
EXTRACTOR KIT

00949

0927

00925

00926

00567

00839

00915

00309

**POF-USA CMR DI UPPER RECEIVER COMPONENTS BY SKU NUMBER**

**REV DATE: 10/16/2020**

4

3

2

1